

256TCL

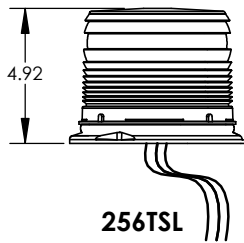

256TSL

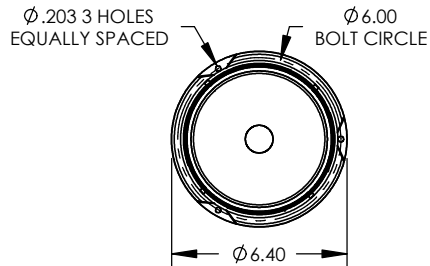

FLANGE or PIPE MOUNT - PIPE SIZE - 1-11<sup>1</sup>/<sub>2</sub> NPT

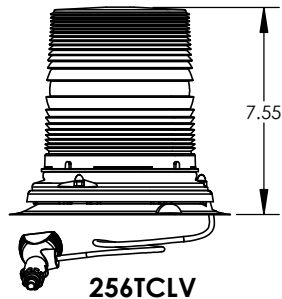

256TCLV

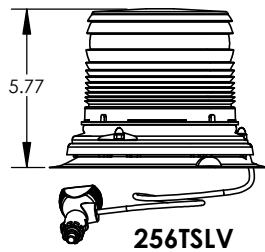

256TSLV

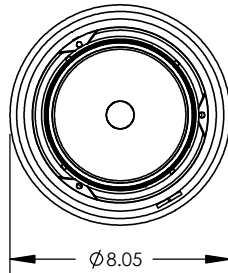

VACUUM MAGNET MOUNT

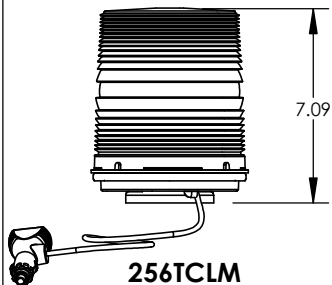

256TCLM

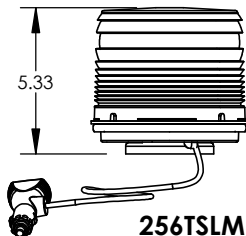

256TSLM

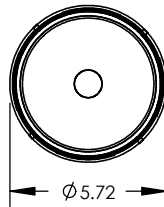

MAGNET MOUNT

REV.	ECR	DESCRIPTION	DATE
-	12178	INITIAL DRAWING REQUEST	8/21/14
A	12428	ADDED 12V ONLY MODEL INFORMATION	01/07/15

**12-24V MODELS AVAILABLE**

MODEL	DESCRIPTION
256TCL-A	256 C-2 LED TALL DOME BEACON - AMBER
256TCL-C	256 C-2 LED TALL DOME BEACON - CLEAR
256TSL-A	256 C-2 LED SHORT DOME BEACON - AMBER
256TSL-C	256 C-2 LED SHORT DOME BEACON - CLEAR
256TCLV-A	256 C-2 LED VAC MAGNET TALL DOME BEACON - AMBER
256TCLV-C	256 C-2 LED VAC MAGNET TALL DOME BEACON - CLEAR
256TSLV-A	256 C-2 LED VAC MAGNET SHORT DOME BEACON - AMBER
256TSLV-C	256 C-2 LED VAC MAGNET SHORT DOME BEACON - CLEAR
256TCLM-A	256 C-2 LED MAGNET TALL DOME BEACON - AMBER
256TCLM-C	256 C-2 LED MAGNET TALL DOME BEACON - CLEAR
256TSLM-A	256 C-2 LED MAGNET SHORT DOME BEACON - AMBER
256TSLM-C	256 C-2 LED MAGNET SHORT DOME BEACON - CLEAR

**12V ONLY MODELS AVAILABLE**

MODEL	DESCRIPTION
256TCL-12V-A	256 C-2 LED TALL DOME BEACON - AMBER
256TSL-12V-A	256 C-2 LED SHORT DOME BEACON - AMBER
256TSL-12V-C	256 C-2 LED SHORT DOME BEACON - CLEAR

**PRODUCT INFORMATION ON PAGE 2**

**UNLESS OTHERWISE SPECIFIED**  
 DIMENSIONS ARE IN INCHES  
 TOLERANCES:  
 ANGULAR: ± 2 DEG.  
 .X ± .100  
 .XX ± .020  
 .XXX ± .005  
 .XXXX ± .001

RoHS COMPLIANT: Yes

MATERIAL:

N/A

FINISH:

N/A

DRAWN BY: SWN

**DRAWING APPROVED BY ECR**

THE INFORMATION CONTAINED IN THIS DRAWING IS THE SOLE PROPERTY OF STAR HEADLIGHT & LANTERN CO., INC.. ANY REPRODUCTION IN PART OR AS A WHOLE WITHOUT THE WRITTEN PERMISSION OF STAR HEADLIGHT & LANTERN CO., INC. IS STRICTLY PROHIBITED.

**STAR HEADLIGHT & LANTERN CO., INC.**

455 Rochester St. Avon NY 14414  
 Ph:(585) 226-9500 Fax: (585) 226-2029

MODEL: 256TSL, TCL, TSLM, TCLM, TSLV, TCLV

TITLE:  
 256 SERIES CLASS 2 MODEL DRAWING

DWG. NO.

256 C-2

REV

A

SCALE: 1:12

DO NOT SCALE FROM DRAWING

SHEET 1 OF 2

REV.	ECR	DESCRIPTION	DATE
-	12178	INITIAL DRAWING REQUEST	8/21/14
A	12428	ADDED 12V ONLY MODEL INFORMATION	01/07/15

FOR OTHER CLASS 2 BEACONS  
SEE MODEL DRAWING 240 C-2

**-- 12V ONLY PRODUCT INFORMATION --**

- ELECTRICAL
  - VOLTAGE: 10 -16VDC
  - AMP DRAW: 0.43 MAX
  - REQUIRES 5 AMP FUSE
  - 3-WIRE CONNECTION or CIG PLUG
    - BLACK - NEG. GROUND
    - RED - + POWER
    - GREEN - PATTERN SELECT
  - WIRE - 18AWG 6" LONG
  - CIG PLUG LENGTH - 12'
  - 28 FLASH PATTERNS
- APPROVALS
  - SAE CLASS II
- MECHANICAL:
  - BASE: POLYCARBONATE
  - DOME: POLYCARBONATE
  - MOUNTING: SURFACE OR POLE or MAGNET
  - GASKET and MOUNTING HARWARE INCLUDED

**-- 12-24V PRODUCT INFORMATION --**

- ELECTRICAL
  - VOLTAGE: 10 -30VDC
  - AMP DRAW: AVG. 0.4A
  - REQUIRES 5 AMP FUSE
  - 3-WIRE CONNECTION or CIG PLUG
    - BLACK - NEG. GROUND
    - RED - + POWER
    - GREEN - PATTERN SELECT
  - WIRE - 18AWG 6" LONG
  - CIG PLUG LENGTH - 12'
  - 28 FLASH PATTERNS
- APPROVALS
  - SAE CLASS II
- MECHANICAL:
  - BASE: POLYCARBONATE
  - DOME: POLYCARBONATE
  - MOUNTING: SURFACE OR POLE or MAGNET
  - GASKET and MOUNTING HARWARE INCLUDED

UNLESS OTHERWISE SPECIFIED DIMENSIONS ARE IN INCHES TOLERANCES: ANGULAR: ± 2 DEG. .X ± .100 .XX ± .020 .XXX ± .005 .XXXX ± .001	DRAWN BY: SWN	<b>STAR HEADLIGHT &amp; LANTERN CO., INC.</b> 455 Rochester St. Avon NY 14414 Ph:(585) 226-9500 Fax: (585) 226-2029 MODEL: 256TSL, TCL, TSLM, TCLM, TSLV, TCLV TITLE: 256 SERIES CLASS 2 MODEL DRAWING
	DRAWING APPROVED BY ECR	
RoHS COMPLIANT: Yes	THE INFORMATION CONTAINED IN THIS DRAWING IS THE SOLE PROPERTY OF STAR HEADLIGHT & LANTERN CO., INC.. ANY REPRODUCTION IN PART OR AS A WHOLE WITHOUT THE WRITTEN PERMISSION OF STAR HEADLIGHT & LANTERN CO., INC. IS STRICTLY PROHIBITED.	
MATERIAL: N/A	DWG. NO.	REV
FINISH: N/A	256 C-2	A
	SCALE: 1:12	DO NOT SCALE FROM DRAWING
	SHEET 2 OF 2	