

REV.	ECR	DESCRIPTION	DATE
-	16232	INITIAL DRAWING REQUEST	10/29/18
A	16611	NOW FORML REV:001	5/16/2019

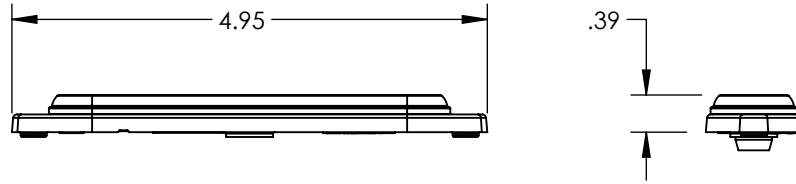
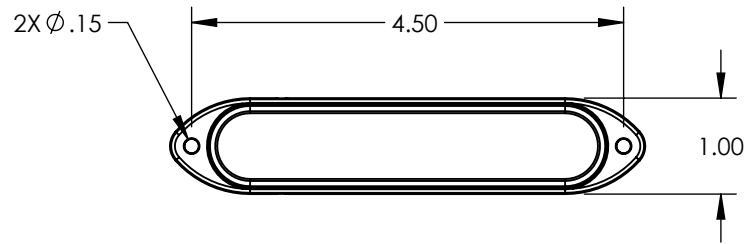

SPECIFICATIONS:

Input Voltage Range: 9-32VDC
 Current Draw: 0.8A ave., 1.5A Peak @ 12.8VDC
 Operating Temperature Range: -40C to 55C
 Connections: 8 inch (min.) wires exiting the unit.
 Permanent Mounting: 2 Hole Pattern 4.5"

Materials:

Module Lens: Polycarbonate
 Mounting Hardware: Stainless Steel
 Heat Sink: Die cast Aluminum
 Mounting Gasket: EPDM Foam Rubber

Connections:

22 Gage Yellow with Green VDC
 22 Gage Yellow with Black VDC
 22 Gage Yellow with Red VDC
 22 Gage Black Wire: Negative VDC
 22 Gage Green Wire: Pattern Select
 22 Gage White: Synchronization

Model Colors: See CHART 1

CHART 1

MODEL	CLASSIFICATION
DLITMC-RBW	SAE J595 CLASS I
DLITMC-RBA	SAE J595 CLASS I
DLITMC-RAW	SAE J595 CLASS I
DLITMC-ABW	SAE J595 CLASS I
DLITMC-AGW	+SAE J595 CLASS I
DLITMC-AW	SAE J595 CLASS I

+ FOR AMBER AND WHITE ONLY

MODEL COLOR DEFINITIONS:

A: AMBER
 B: BLUE
 G: GREEN
 R: RED
 W: WHITE

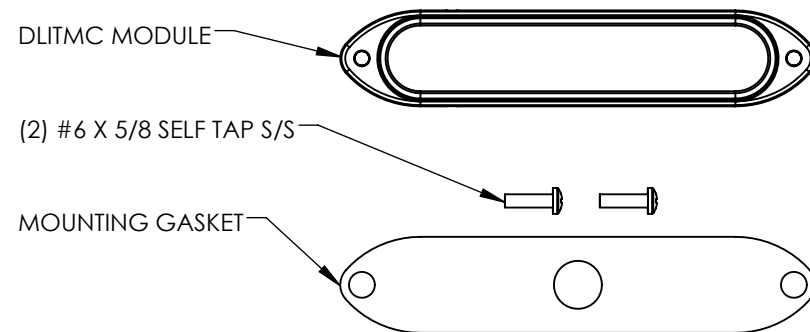

UNLESS OTHERWISE SPECIFIED DIMENSIONS ARE IN INCHES TOLERANCES: ANGULAR: ± 2 DEG. .X ± .100 .XX ± .020 .XXX ± .005 .XXXX ± .001	DRAWN BY: MD	STAR HEADLIGHT & LANTERN CO., INC. 455 Rochester St. Avon NY 14414 Ph:(585) 226-9500 Fax: (585) 226-2029
	DRAWING APPROVED BY ECR	
RoHS COMPLIANT: Yes	THE INFORMATION CONTAINED IN THIS DRAWING IS THE SOLE PROPERTY OF STAR HEADLIGHT & LANTERN CO., INC.. ANY REPRODUCTION IN PART OR AS A WHOLE WITHOUT THE WRITTEN PERMISSION OF STAR HEADLIGHT & LANTERN CO., INC. IS STRICTLY PROHIBITED.	MODEL: DLITMC-*** REV:001
MATERIAL: N/A		TITLE: MODEL DRAWING
FINISH: N/A		DWG. NO. DLITMC REV 001 REV A
		SCALE: 1:2 DO NOT SCALE FROM DRAWING SHEET 1 OF 1