

ITEM NO.	PART NUMBER	DESCRIPTION	QTY
1	P30090-2	#4-40 KEP NUT STEEL ZN PLATE	2
2	P30150-496P	DLIT GRILL PLATE CLAMP	1
3	S30150-497	DLIT GRILL PLATE	1
4	P30052-24	6-32 X 3/8" PHILIPS, PAN, SS, BLACK	2
5	P30050-49	#4-40 X 2" PHIL FLAT MS S/S	2
6	P30155-2	ISOLATION GROMMET	1
7	PLIT610	INSTRUCTION SHEET	1
8	P30024-24	7X7 POLY BAG	1
9	PLAB21X2WHI	KIT LABEL	1

△ B

REV.	ECR	DESCRIPTION	DATE
A	17594	INITIAL DRAWING REQUEST	10/29/2020
B	18240	POLYBAG CHANGED FROM P30024-16 TO P30024-24	11/10/2021

HEAT SEAL

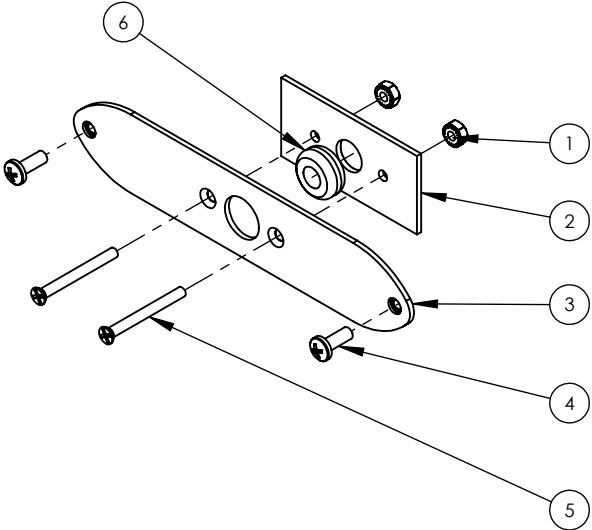
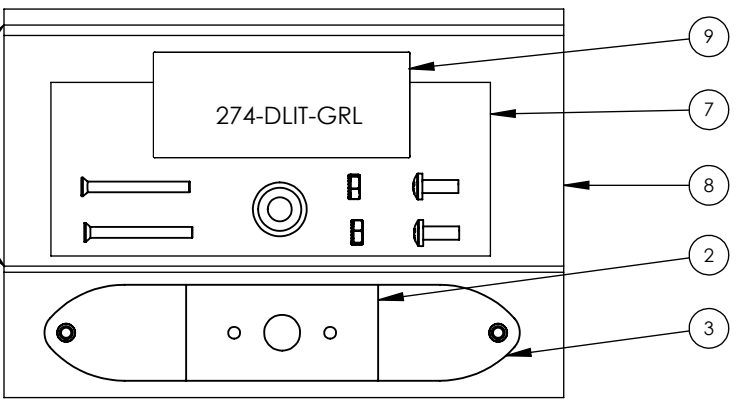

<b>UNLESS OTHERWISE SPECIFIED</b> DIMENSIONS ARE IN INCHES TOLERANCES: ANGULAR: ± 2 DEG. .X ± .100 .XX ± .020 .XXX ± .005 .XXXX ± .001	DRAWN BY: MD	<b>STAR HEADLIGHT &amp; LANTERN CO., INC.</b> 455 Rochester St. Avon NY 14414 Ph:(585) 226-9500 Fax: (585) 226-2029
	<b>DRAWING APPROVED BY ECR</b> THE INFORMATION CONTAINED IN THIS DRAWING IS THE SOLE PROPERTY OF STAR HEADLIGHT & LANTERN CO., INC.. ANY REPRODUCTION IN PART OR AS A WHOLE WITHOUT THE WRITTEN PERMISSION OF STAR HEADLIGHT & LANTERN CO., INC. IS STRICTLY PROHIBITED.	
RoHS COMPLIANT: YES	MODEL: 274-DLIT-GRL	TITLE: <b>DLIT GRILL MOUNT KIT</b>
MATERIAL: N/A	DWG. NO. 274-DLIT-GRL	REV B
FINISH: N/A	SCALE: 1:2 DO NOT SCALE FROM DRAWING	SHEET 1 OF 1